

« AGE EXCEPTION »
Global anti-aging



250 ml bottle + box of 12 individual masks

Serum pH 6.3 approx.

EXCLUSIVE PROFESSIONAL USE

MASQUE CELL-ENERGY

CELL-ENERGY SERUM
+ 12 BIOCELLULOSE MASK

COMPLETE YOUTH-REVEALING
ANTI-AGING MASK

with Cell-Energy serum

ESSENTIAL ACTIONS AND INGREDIENTS

MASQUE BIOCELLULOSE MASK

Stems from the fermentation of coconut juice

CELL-ENERGY SERUM

Cellular longevity
boosts cellular
longevity proteins

Cellular energy accelerates
the synthesis of ATP
(cell's energy reserve)

Cellular communication
restores clear communication
between cells

Defense potential
reinforces the defense potential
of the skin against assaults

Cellular oxygenation
oxygenates skin cells and
improves skin radiance

Vitalizing - replenishing effect

▶ **alanine-based lipo-aminoacid**, derived from biotechnology
Baicaline, a polyphenol extracted from Scutellaria Baicalensis root

▶ **D-ribose** - natural complex sugar derived from corn

▶ **lipo-aminoacid**

▶ **lipo-aminoacid**

▶ **garden nasturtium extract** (Tropaeolum Majus) rich in arabinogalactan

▶ **Yon-Ka Quintessence** bergamot, lemon, mandarin, rose, tonka bean and guaiac wood E.O.

KEYWORDS TO SUCCESSFUL SELLING

- Biocellulose technology
 - Used in reconstructive surgery
 - Natural « tissue », issued from biotechnology
- Second skin effect leading to a feeling of unequalled softness and comfort
- 3D structure of the mask to hug the skin's forms : maximum efficiency
- French production CELL-ENERGY SERUM
- Promotes the « reinitialization » of the skin's youth code
- Tolerance tested by dermatologists
- Non comedogenic

DIRECTIONS FOR USE

Mask preparation

1. Open the packet and place the folded BIOCELLULOSE MASK into a shallow dish.
2. Pour 20 ml of EMULSION CONCENTREE diluted to 5 V onto the mask (or 12 V for sensitive skin types) and soak it in with your fingertips.
3. Pour 20 ml of CELL-ENERGY SERUM into the measuring cup.

Mask application

4. Apply CELL-ENERGY SERUM (½ dose) to the face only, using a brush.
5. Take the BIOCELLULOSE MASK. Remove the first protective layer and apply the biocellulose sheet to the face.
6. Remove the second protective layer and add more CELL-ENERGY SERUM (¼ dose) to the mask with a brush.
7. On the décolleté and neck: perform lift and roll, kneading techniques first, then apply the rest of CELL-ENERGY SERUM, using a brush.
8. Leave the BIOCELLULOSE MASK on for 10 minutes. Use gentle pressure with the fingers to help absorb the product and, if necessary, wipe off any surplus with a tissue. Do not rinse

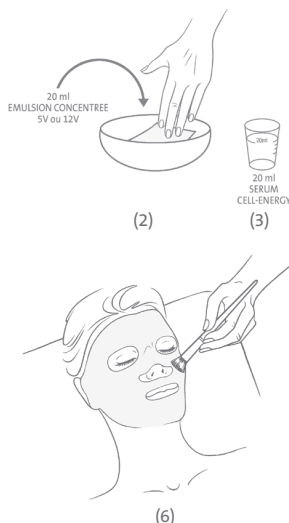

Remember

- Complete youth-revealing anti-aging mask
- 100% natural biocellulose technology
- Yon-Ka's exclusive CELL-ENERGY SERUM of french production